

California Theatre

345 South 1st Street, San Jose, CA 95113 • 800-SAN-JOSE
www.sanjosetheaters.org



Fast Facts

- Located across the street from the San Jose Convention Center
- 1,122 seating capacity, including up to 14 ADA-Compliant seats
- 687 Orchestra seats
- 435 Balcony seats, including 196 Grand Tier seats and 239 Mezzanine seats
- Accommodates 130 Banquet-style seats in main lobby and foyer areas
- Stage Size: 90' x 40'
- Stage Proscenium opening: 31'6" x 44'
- State-of-the-art audio visual technology
- Full staging and production capabilities
- Home to Opera San Jose and Symphony Silicon Valley
- Walking distance to surrounding hotels, restaurants, bars and nightlife

Venue Synopsis

The California Theatre, widely recognized as one of the best-preserved examples of 1920s-era movie palaces, adds glamour and class to any performance, film screening, concert, meeting, private party or special event.

A major renovation of this gorgeous venue was completed in the early 2000s, with over 75 million dollars invested in restoration and facility upgrades. The main theatre features plush seating and impressive acoustics. Additional event-ready spaces include three meeting rooms and a stylish private courtyard. The theatre's grand foyer and beautiful lobby provide additional options for presentations, banquets, cocktail receptions and weddings.

Located across the street from the San Jose Convention Center, the theatre is within easy walking distance of several parking lots and numerous restaurants in the creative hub of Downtown known as the South First Area (SoFA) District.

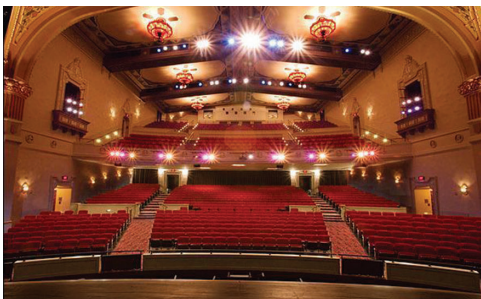

California Theatre

Seating Plan

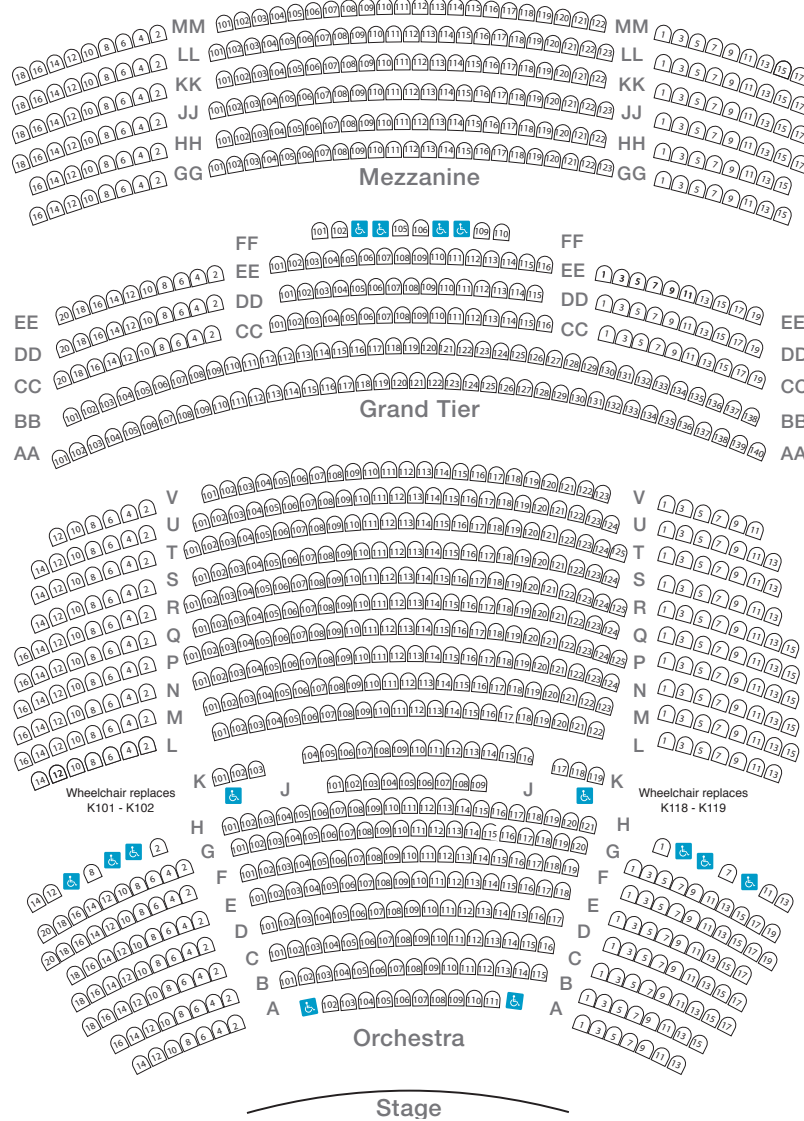

Balcony Level

Orchestra Level

Location	Capacity	Orchestra Level Seating Capacity	Balcony Level Seating Capacity (Grand Tier & Mezzanine)	Grand Tier Seating Capacity	Mezzanine Seating Capacity	Stage Size (W x H)	Active Stage Area	Stage Proscenium Opening (W x H)
California Theatre	1,122 Total 1,108 Fixed 12 - 14 Wheelchair areas	687 Total 677 Fixed 8 - 10 Wheelchair areas (*Fixed seats K101 - K102 & K118 - K119 can be removed to accommodate an additional wheelchair on each side)	435 Total 431 Fixed 4 Wheelchair areas	196 Total 192 Fixed 4 Wheelchair areas	239 Fixed	90' x 40'	60' x 40'	31' 6" x 44'

California Theatre

Balcony Level

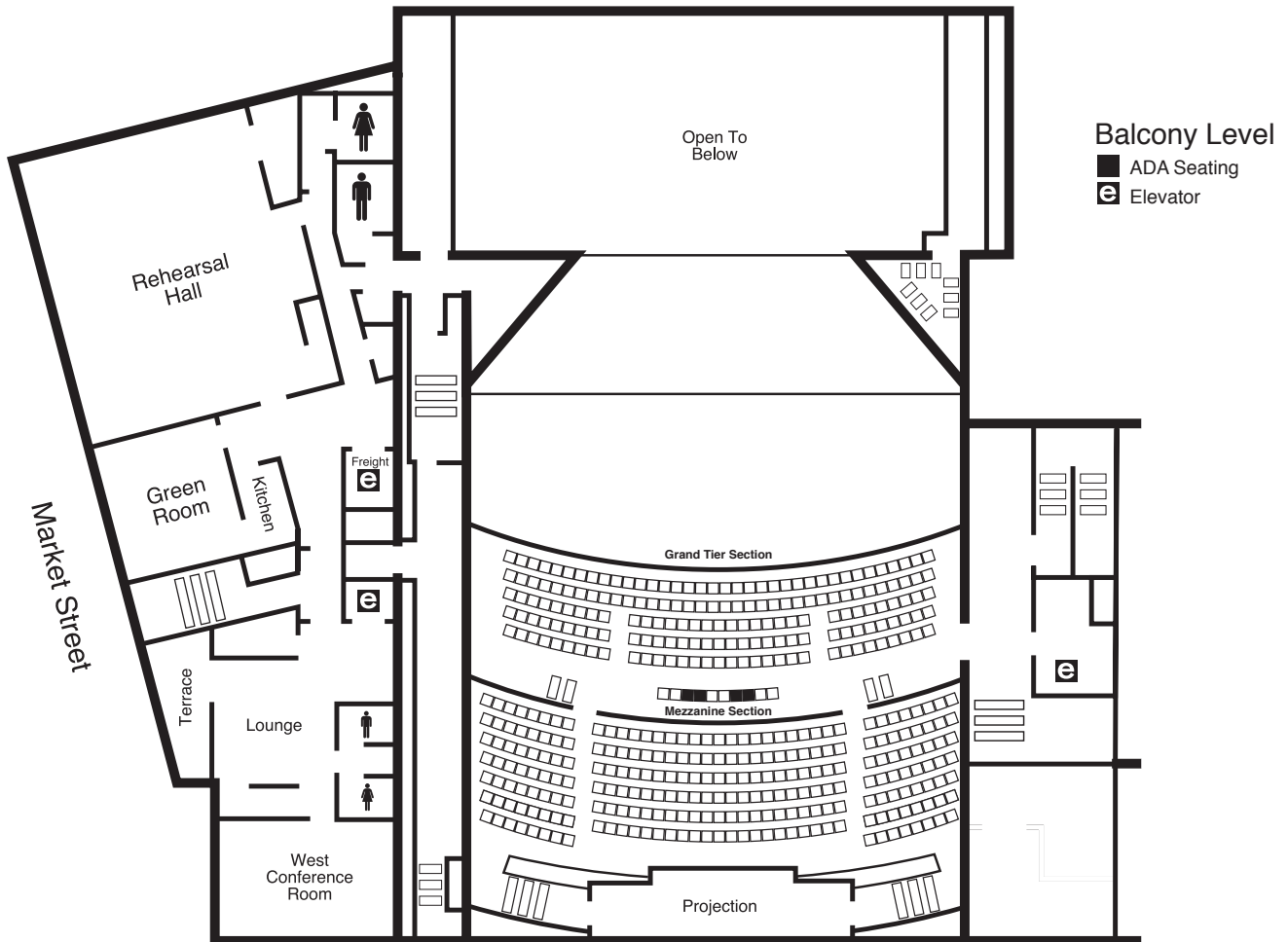

Location	Capacity	Orchestra Level Seating Capacity	Balcony Level Seating Capacity (Grand Tier & Mezzanine)	Grand Tier Seating Capacity	Mezzanine Seating Capacity	Stage Size (W x H)	Active Stage Area	Stage Proscenium Opening (W x H)
California Theatre	1,122 Total 1,108 Fixed 12 - 14 Wheelchair areas	687 Total 677 Fixed 8 - 10 Wheelchair areas (*Fixed seats K101 - K102 & K118 - K119 can be removed to accommodate an additional wheelchair on each side)	435 Total 431 Fixed 4 Wheelchair areas	196 Total 192 Fixed 4 Wheelchair areas	239 Fixed	90' x 40'	60' x 40'	31' 6" x 44'